

WEBB ULTRA GRIP™

High performance heavy-duty calipers, carriers and assemblies from **the brand you know and trust**



Your Wheel-End Experts

www.WebbADB.com



A Marmon | Berkshire Hathaway Company

CONTENTS/FEATURES

Contents	Page
Features/Contents/About	2-3
Identification	4-5
NS225 Calipers for Transit, Motor Coach, Tour Bus & Specialized	6-11
LN225 Calipers for Transit, Motor Coach, Tour Bus & Specialized	12-13
MC225 Calipers for Truck, Trailer, Coach	14-17
& ZF Axles	
Heavy Duty NH225 Refuse and Transit	18
Kits and Accessories.....	19
Glossary.....	20
Fitting Instructions.....	21-24
Warranty.....	25
Cross Reference:	26

WEBB
ULTRA
GRIP[™]



Twin return springs with a unique actuation block helps eliminate caliper or lever binding.



Durable ductile iron housing with special formulation provides increased strength and durability under punishing conditions.

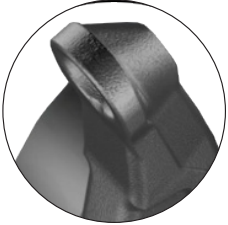

Lever profile precision machined to ensure correct brake performance.



Improved sealing gives better protection against water ingress providing longer product life.



Adjustment mechanism, unique to Webb ADB, improves efficiency and helps prevent over-adjustment to reduce pad and rotor wear.

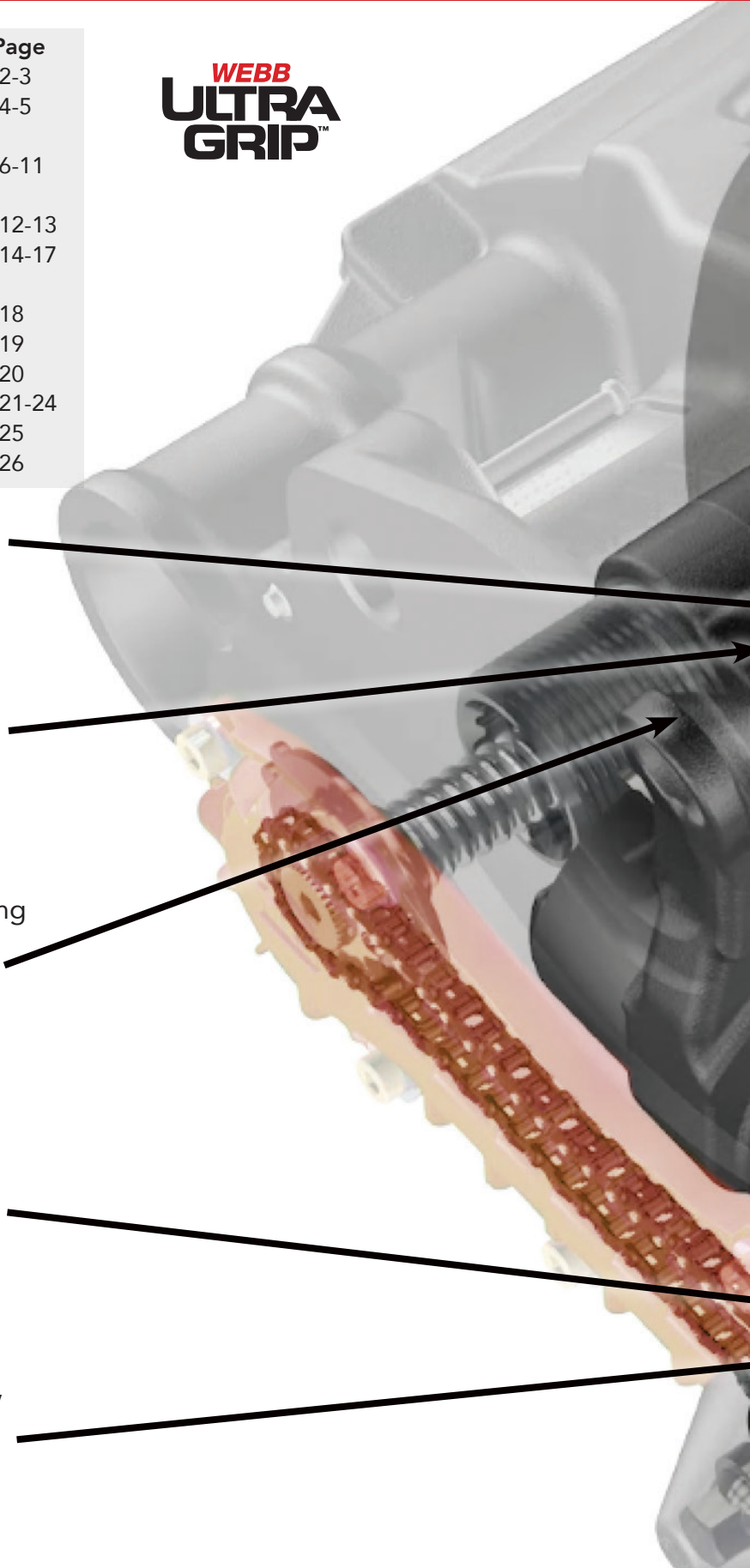



Webb Wheel Products, Inc. is part of Marmon Holdings, Inc., which is a Berkshire Hathaway company consisting of 11 diverse, stand-alone business groups and 120+ autonomous manufacturing and service businesses worldwide. With \$12 billion in annual revenue, Marmon is the biggest small business you'll ever find. Transportation Products Group is the organization supporting the heavy-duty highway transportation industry, and Webb Wheel Products, Inc. is a business leader within this group that focuses on serving its customers with world-class brake solutions.

IDENTIFICATION

WEBB Air Disc Brake Calipers are identified by the part number which is marked on the ID plate.

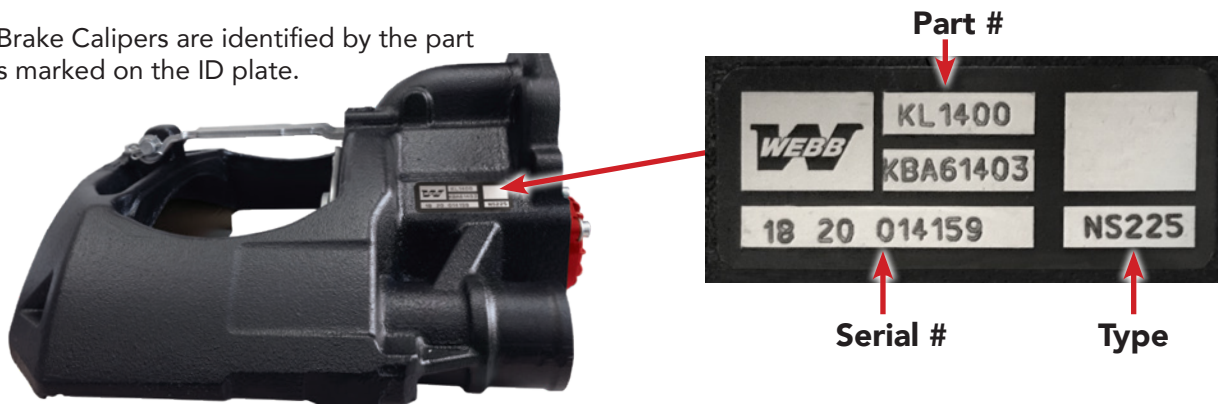

After a long life in service or while still on the vehicle it can be difficult to read the information on the ID plate. Therefore the following can be useful in assisting identification.

- Looking from the air chamber side (rear), if there are bolts visible as shown, the brake is an MC225 typically used on trucks, trailers and some motor coach vehicles. If there are no bolts the brake is a NS225 typically used on transit buses and other specialized applications. LN225 are the +93° mounting angle

MC225 - two visible bolts near short and long guide sleeve ports

NS225 - no bolts visible

LN225 - Radial Caliper Design

NH225 - HD Caliper Design

No chain cover, cable fitments or sensors.



- Next, check the air chamber mounting angle. This ranges from "0" degree to "+93" degrees.



IDENTIFICATION

3 Next, check if the Long Guide Sleeve is on Left or Right as shown.



4 Check the chain cover to determine if it is plain or includes a sensor.

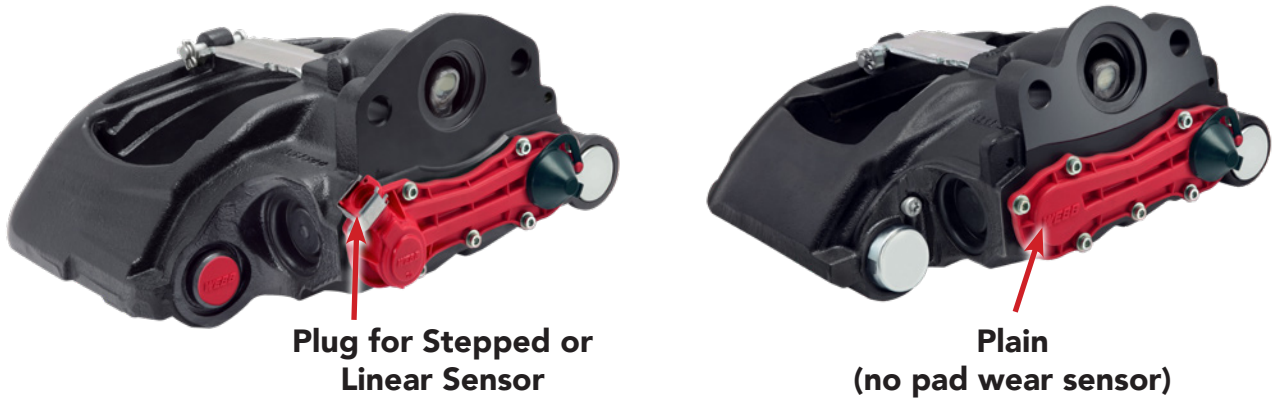

5 Check sensor type if applicable.

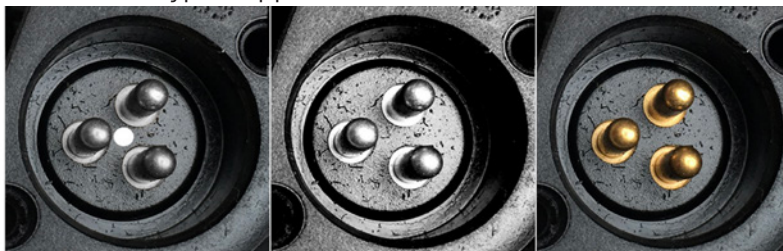

On/Off Sensor:
Silver colored pins and white dot in middle

Linear
Silver colored pins and no white dot in middle

Stepped
Gold colored pins

Caliper Type: NS225

Caliper and Caliper Assemblies

Typically used on transit buses and other specialized applications.

WEBB
ULTRA
GRIP™
with
Enviroshield
Technology

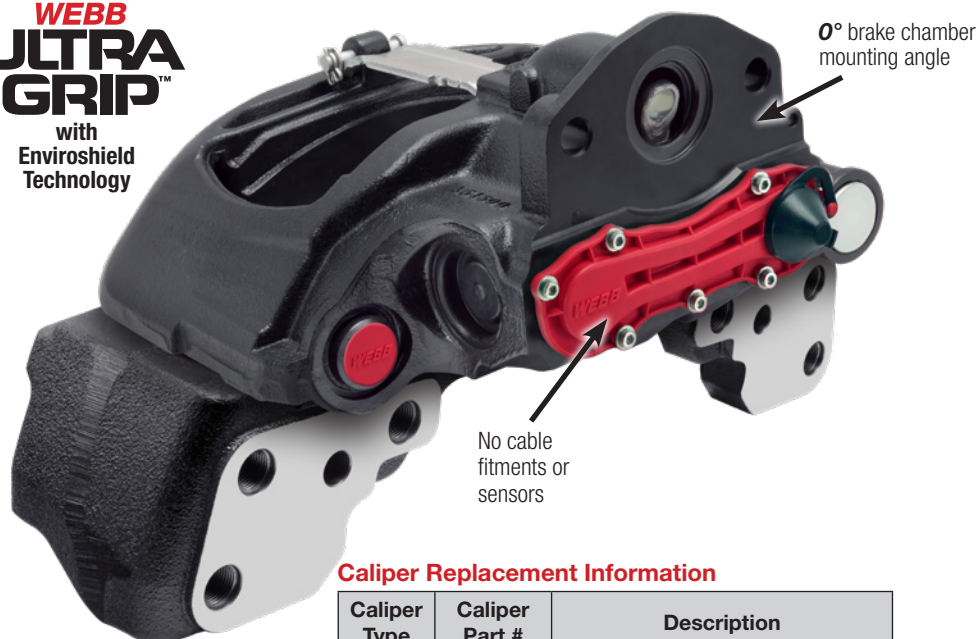

Caliper Replacement Information

Caliper Type	Caliper Part #	Description
NS225	KL1400	Left long guide sleeve
	KR1400	Right long guide sleeve

Product Information

Applications:	Van Hool / New Flyer
Brake chamber mounting angle:	0°
Sensor Type:	None

Caliper/Carrier Replacement Information

NS225	KL1400-01	LH long guide sleeve / 0° mounting angle / no sensor / carrier attached
	KR1400-01	RH long guide sleeve / 0° mounting angle / no sensor / carrier attached

Carrier Replacement Information

NS225	KT1001	Both right and left long guide sleeves
-------	--------	--

Installation Kits Include



Available Service Kits



Caliper/Carrier Assemblies



Calipers



Carrier



For additional service kits refer to page 18.

Manufacturers' and other wholesaler's part numbers used in this catalog are for cross reference purposes only and do not imply anything about the origin or manufacturer of the product.

Caliper Type: NS225

Caliper and Caliper Assemblies

Typically used on transit buses and other specialized applications.

WEBB
ULTRA
GRIP™
with
Enviroshield
Technology

Sensor type: *stepped*



Caliper/Carrier Assemblies



Part #: **KL1400A-01**
Left long guide sleeve



Part #: **KR1400A-01**
Right long guide sleeve

Caliper Replacement Information

Caliper Type	Caliper Part #	Description
NS225	KL1400A	Left long guide sleeve with stepped sensor
	KR1400A	Right long guide sleeve with stepped sensor

Caliper/Carrier Replacement Information

NS225	KL1400A-01	LH long guide sleeve / 0° mounting angle / stepped sensor / carrier attached
	KR1400A-01	RH long guide sleeve / 0° mounting angle / stepped sensor / carrier attached

Carrier Replacement Information

NS225	KT1001	Both right and left long guide sleeves
-------	--------	--

Product Information

Applications:	New Flyer
Brake chamber mounting angle:	0°
Sensor Type:	Stepped

Calipers



Part #: **KL1400A**
Left long guide sleeve



Part #: **KR1400A**
Right long guide sleeve

Installation Kits Include



Guide Sleeves

Pad Retainer

PWWI Pin

Carrier



Part #: **KT1001**

Available Service Kits



Tappet Boot Kit
KS0400



Guide Sleeve Kit
KS0215



Chain Cover Kit with Stepped Sensor (Use with screw-on or clip-on connectors)
KS0340

For additional service kits refer to page 18. Manufacturers' and other wholesaler's part numbers used in this catalog are for cross reference purposes only and do not imply anything about the origin or manufacturer of the product.

Caliper Type: NS225

Caliper and Caliper Assemblies

Typically used on motor coaches, tour buses, and other specialized applications.

WEBB
ULTRA
GRIP™
with
Enviroshield
Technology

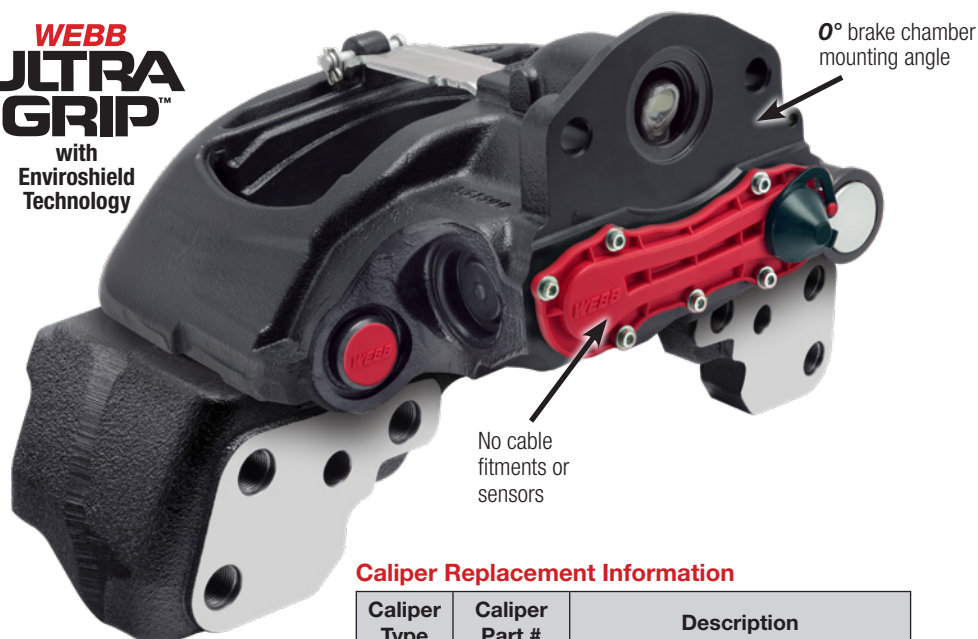

Caliper Replacement Information

Caliper Type	Caliper Part #	Description
NS225	KL1400	Left long guide sleeve
	KR1400	Right long guide sleeve

Product Information

Applications:	Prevost
Brake chamber mounting angle:	0°
Sensor Type:	None

Caliper/Carrier Replacement Information

NS225	KL1400-02	LH long guide sleeve / 0° mounting angle / no sensor / carrier attached
	KR1400-02	RH long guide sleeve / 0° mounting angle / no sensor / carrier attached

Carrier Replacement Information

NS225	KT1002	Both right and left long guide sleeves
-------	--------	--

Installation Kits Include



Available Service Kits



Caliper/Carrier Assemblies



Calipers



Carrier



For additional service kits refer to page 18.

Manufacturers' and other wholesaler's part numbers used in this catalog are for cross reference purposes only and do not imply anything about the origin or manufacturer of the product.

Caliper Type: NS225

Caliper and Caliper Assemblies

Typically used on motor coaches, tour buses, and other specialized applications

WEBB
ULTRA
GRIP™
with
Enviroshield
Technology



Caliper/Carrier Assemblies



Part #: **KL1400-07**
Left long guide sleeve



Part #: **KR1400-07**
Right long guide sleeve

Caliper Replacement Information

Caliper Type	Caliper Part #	Description
NS225	KL1400	Left long guide sleeve
	KR1400	Right long guide sleeve

Caliper/Carrier Replacement Information

NS225	KL1400-07	LH long guide sleeve / 0° mounting angle / no sensor / carrier attached
	KR1400-07	RH long guide sleeve / 0° mounting angle / no sensor / carrier attached

Carrier Replacement Information

NS225	KT1007	Both right and left long guide sleeves
-------	--------	--

Product Information

Applications:	Prevost
Brake chamber mounting angle:	0°
Sensor Type:	None

Calipers



Part #: **KL1400**
Left long guide sleeve



Part #: **KR1400**
Right long guide sleeve

Installation Kits Include



Available Service Kits



Carrier



For additional service kits refer to page 18. Manufacturers' and other wholesaler's part numbers used in this catalog are for cross reference purposes only and do not imply anything about the origin or manufacturer of the product.

Caliper Type: NS225

Caliper and Caliper Assemblies

Typically used on motor coaches, tour buses, and other specialized applications.

WEBB
ULTRA
GRIP™
with
Enviroshield
Technology

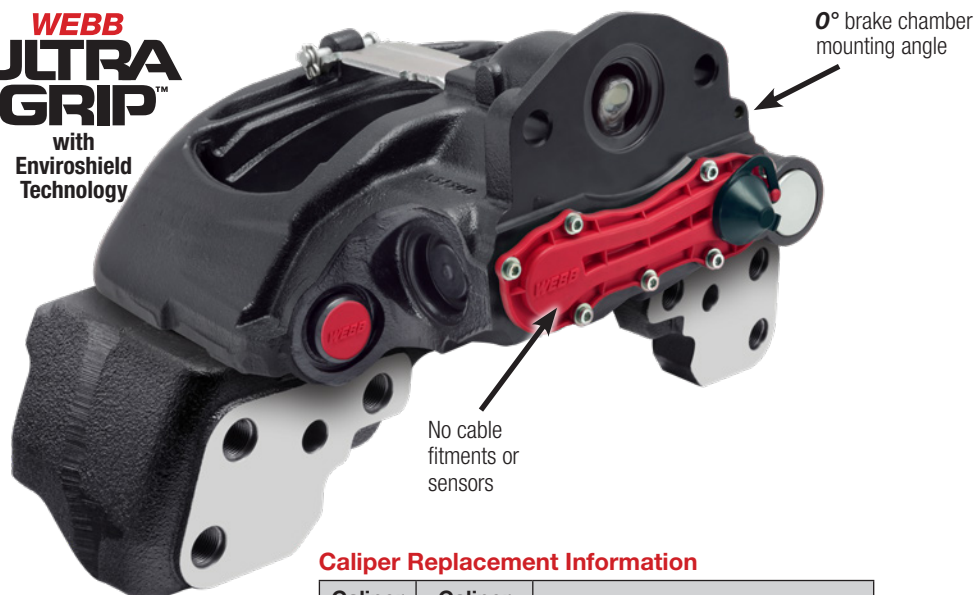

Caliper Replacement Information

Caliper Type	Caliper Part #	Description
NS225	KL1400	Left long guide sleeve
	KR1400	Right long guide sleeve

Product Information

Applications:	Prevost
Brake chamber mounting angle:	0°
Sensor Type:	None

Caliper/Carrier Replacement Information

NS225	KL1400-08	LH long guide sleeve / 0° mounting angle / no sensor / carrier attached
	KR1400-08	RH long guide sleeve / 0° mounting angle / no sensor / carrier attached

Carrier Replacement Information

NS225	KT1008	Both right and left long guide sleeves
-------	--------	--

Installation Kits Include



Available Service Kits



Caliper/Carrier Assemblies



Calipers



Carrier



For additional service kits refer to page 18.

Manufacturers' and other wholesaler's part numbers used in this catalog are for cross reference purposes only and do not imply anything about the origin or manufacturer of the product.

Caliper Type: NS225

Caliper and Caliper Assemblies

Typically used on Nova Bus steer axles and other specialized applications.

WEBB
ULTRA
GRIP™
with
Enviroshield
Technology

Caliper/Carrier Assemblies



Caliper Replacement Information

Caliper Type	Caliper Part #	Description
NS225	KL1400B	Left long guide sleeve with linear sensor
	KR1400B	Right long guide sleeve with linear sensor

Caliper/Carrier Replacement Information

NS225	KL1400B-04	LH long guide sleeve / 0° mounting angle / linear sensor / carrier attached
	KR1400B-04	RH long guide sleeve / 0° mounting angle / linear sensor / carrier attached

Carrier Replacement Information

NS225	KT1004	Both right and left long guide sleeves
-------	---------------	--

Product Information

Applications:	Nova Bus
Brake chamber mounting angle:	0°
Sensor Type:	Linear

Calipers



Carrier



Installation Kits Include



Available Service Kits



For additional service kits refer to page 18.
Manufacturers' and other wholesaler's part numbers used in this catalog are for cross reference purposes only and do not imply anything about the origin or manufacturer of the product.

Caliper Type: LN225

Caliper and Caliper Assemblies

Typically used on transit buses and other specialized applications.

WEBB
ULTRA
GRIP™
with
Enviroshield
Technology



Caliper Replacement Information

Caliper Type	Caliper Part #	Description
LN225	KL6900A	Left long guide sleeve
	KR6900A	Right long guide sleeve

Caliper/Carrier Replacement Information

LN225	KL6900A-02	LH long guide sleeve / +93° mounting angle / stepped sensor / carrier attached
	KR6900A-02	RH long guide sleeve / +93° mounting angle / stepped sensor / carrier attached

Carrier Replacement Information

LN225	KT1002	Both right and left long guide sleeves; Dual Drilled for left and right shoulder bolt locations
-------	--------	---

Product Information

Applications:	New Flyer
Brake chamber mounting angle:	+93°
Sensor Type:	Stepped

Installation Kits Include



Available Service Kits



Caliper/Carrier Assemblies



Calipers



Carrier



For additional service kits refer to page 18.

Manufacturers' and other wholesaler's part numbers used in this catalog are for cross reference purposes only and do not imply anything about the origin or manufacturer of the product.

Caliper Type: LN225

Caliper and Caliper Assemblies

Typically used on transit buses and other specialized applications.

**WEBB
ULTRA
GRIP™**
with
Enviroshield
Technology

Caliper/Carrier Assemblies



Part #: **KL6900B-02**
Left long guide sleeve



Part #: **KR6900B-02**
Right long guide sleeve

+93° brake chamber mounting angle

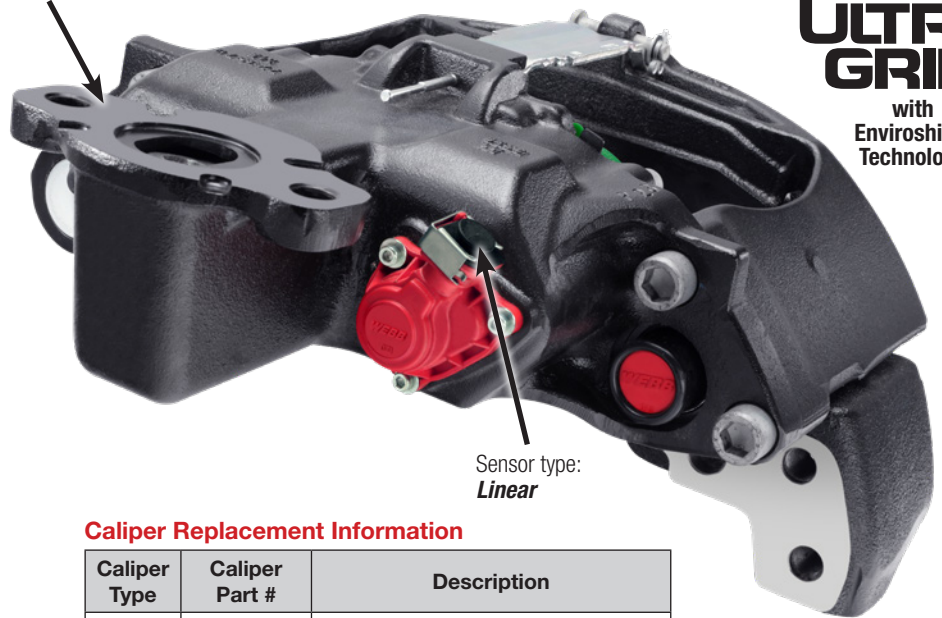

Sensor type:
Linear

Caliper Replacement Information

Caliper Type	Caliper Part #	Description
LN225	KL6900B	Left long guide sleeve
	KR6900B	Right long guide sleeve

Caliper/Carrier Replacement Information

LN225	KL6900B-02	LH long guide sleeve / +93° mounting angle / linear sensor / carrier attached
	KR6900B-02	RH long guide sleeve / +93° mounting angle / linear sensor / carrier attached

Carrier Replacement Information

LN225	KT1002	Both right and left long guide sleeves; Dual Drilled for left and right shoulder bolt locations
-------	---------------	---

Product Information

Applications:	Nova Bus
Brake chamber mounting angle:	+93°
Sensor Type:	Linear

Calipers



Part #: **KL6900B**
Left long guide sleeve



Part #: **KR6900B**
Right long guide sleeve

Installation Kits Include



Available Service Kits



For additional service kits refer to page 18.

Manufacturers' and other wholesaler's part numbers used in this catalog are for cross reference purposes only and do not imply anything about the origin or manufacturer of the product.

Caliper Type: MC225

Caliper and Caliper Assemblies

Typically used on standard trailer applications.

WEBB
ULTRA
GRIP™

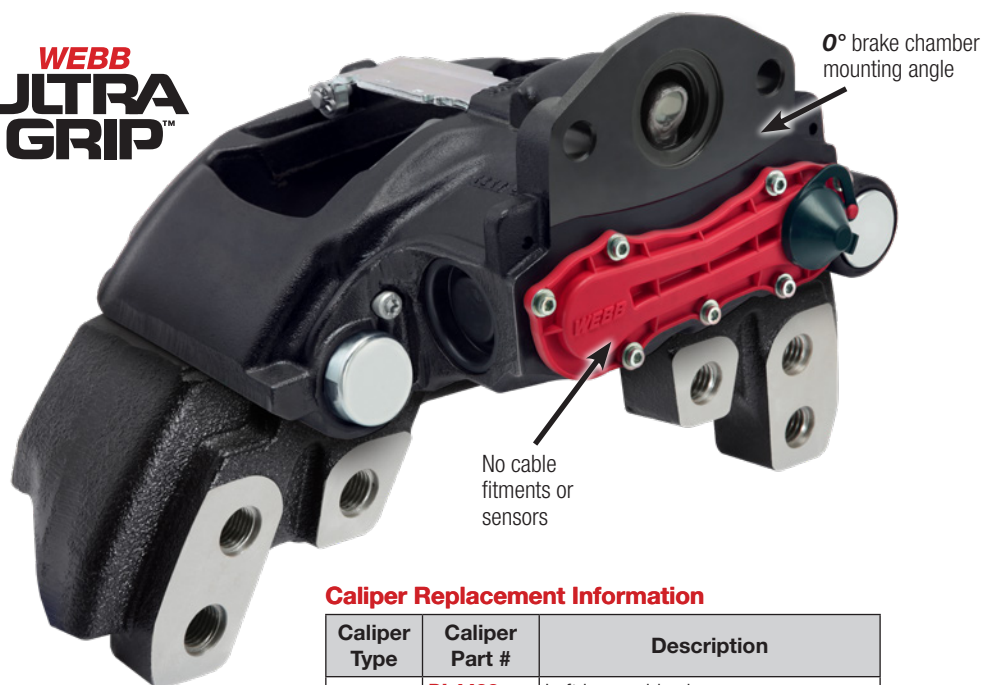

Caliper Replacement Information

Caliper Type	Caliper Part #	Description
MC225	BL4400	Left long guide sleeve
	BR4400	Right long guide sleeve

Caliper/Carrier Replacement Information

MC225	BL4400-40	LH long guide sleeve / 0° mounting angle / no sensor / carrier attached
	BR4400-40	RH long guide sleeve / 0° mounting angle / no sensor / carrier attached

Carrier Replacement Information

MC225	BT4040	Both right and left long guide sleeves
-------	--------	--

Product Information

Applications:	Standard Trailer
Brake chamber mounting angle:	0°
Sensor Type:	None

Installation Kits Include



Available Service Kits



Caliper/Carrier Assemblies



Calipers



Carrier



For additional service kits refer to page 18.

Manufacturers' and other wholesaler's part numbers used in this catalog are for cross reference purposes only and do not imply anything about the origin or manufacturer of the product.

Caliper Type: MC225

Caliper and Caliper Assemblies

Typically used on truck applications.



Caliper/Carrier Assemblies



Part #: **BL4700-41**
Left long guide sleeve



Part #: **BR4700-41**
Right long guide sleeve

No cable fittings or sensors

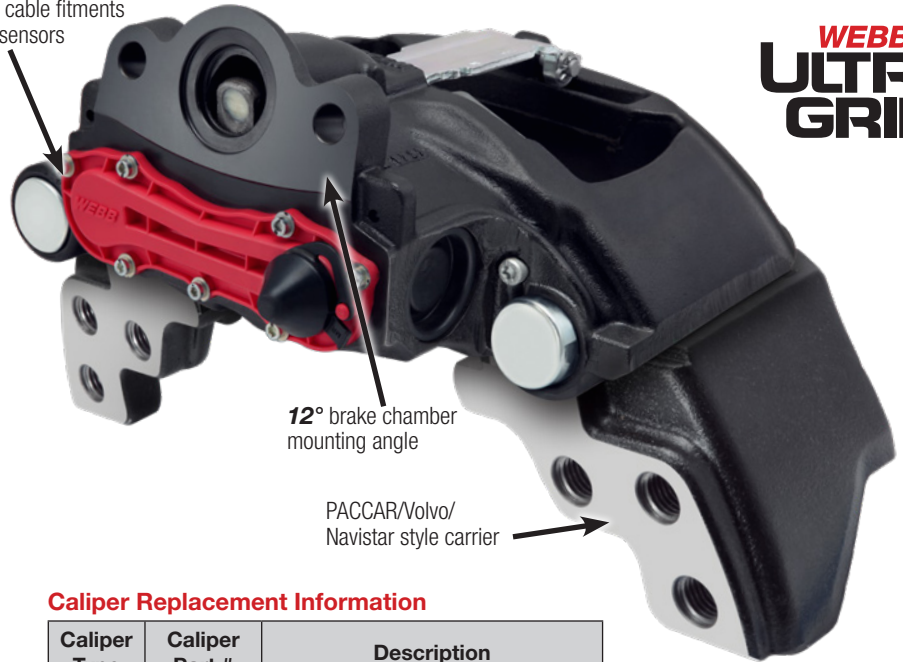

12° brake chamber mounting angle

PACCAR/Volvo/Navistar style carrier

Caliper Replacement Information

Caliper Type	Caliper Part #	Description
MC225	BL4700	Left long guide sleeve
	BR4700	Right long guide sleeve

Caliper/Carrier Replacement Information

MC225	BL4700-41	LH long guide sleeve / 12° mounting angle / no sensor / carrier attached
	BR4700-41	RH long guide sleeve / 12° mounting angle / no sensor / carrier attached

Carrier Replacement Information

MC225	BT4041	Both right and left long guide sleeves
-------	--------	--

Product Information

Applications:	PACCAR, Volvo, Navistar
Brake chamber mounting angle:	12°
Sensor Type:	None

Calipers



Part #: **BL4700**
Left long guide sleeve



Part #: **BR4700**
Right long guide sleeve

Carrier



Part #: **BT4041**

Installation Kits Include

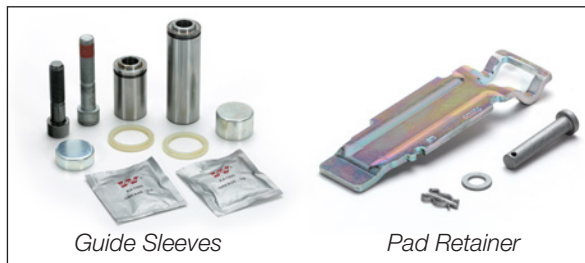

Guide Sleeves

Pad Retainer

Available Service Kits



Tappet Boot Kit
KS0400



Guide Sleeve Kit
KS0205



Chain Cover Kit
KS0300

For additional service kits refer to page 18. Manufacturers' and other wholesaler's part numbers used in this catalog are for cross reference purposes only and do not imply anything about the origin or manufacturer of the product.

Caliper Type: MC225

Caliper and Caliper Assemblies

Typically used on truck applications (tangential).

WEBB
ULTRA
GRIP™

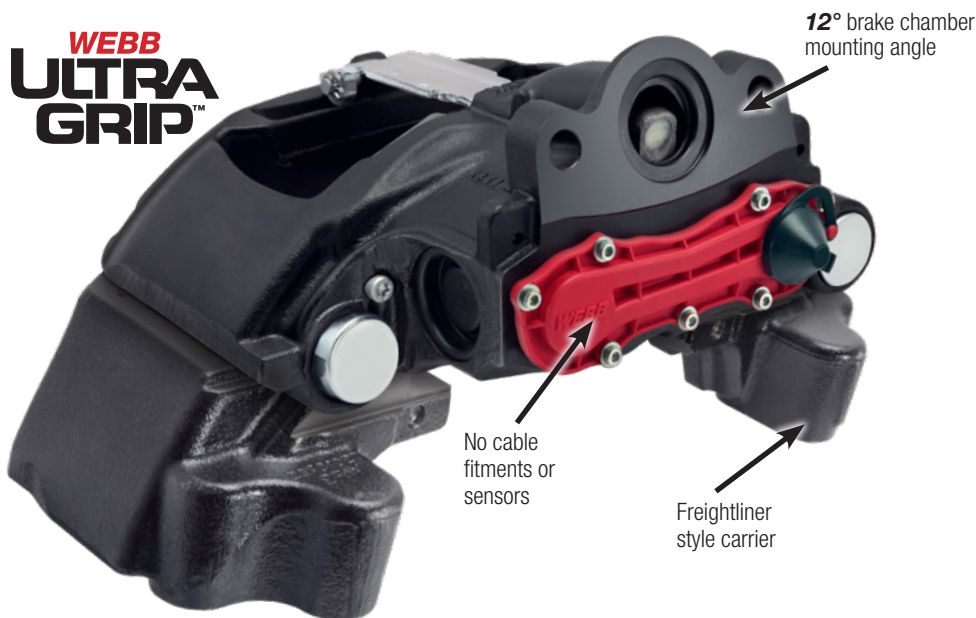

Caliper Replacement Information

Caliper Type	Caliper Part #	Description
MC225	BL4700	Left long guide sleeve
	BR4700	Right long guide sleeve

Caliper/Carrier Replacement Information

MC225	BL4700-42	LH long guide sleeve / 12° mounting angle / no sensor / carrier attached
	BR4700-42	RH long guide sleeve / 12° mounting angle / no sensor / carrier attached

Carrier Replacement Information

MC225	BT4042	Both right and left long guide sleeves
-------	--------	--

Product Information

Applications:	Freightliner
Brake chamber mounting angle:	12°
Sensor Type:	None

Installation Kits Include

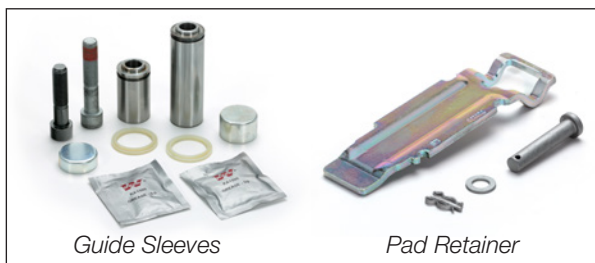

Available Service Kits



For additional service kits refer to page 18.

Manufacturers' and other wholesaler's part numbers used in this catalog are for cross reference purposes only and do not imply anything about the origin or manufacturer of the product.

Caliper/Carrier Assemblies



Calipers



Carrier



Caliper Type: MC225

Caliper and Caliper Assemblies

Typically used on 2015+ MCI Coach & ZF Axles



Caliper/Carrier Assemblies



Left
side fit bolt

Part #: **BL4700-43**
Left long guide sleeve



Left
side fit bolt

Part #: **BR4700-43**
Right long guide sleeve



Right
side fit bolt

Part #: **BL4700-44**
Left long guide sleeve



Right
side fit bolt

Part #: **BR4700-44**
Right long guide sleeve

Calipers

Part #:
BL4700
Left long
guide sleeve



Part #:
BR4700
Right long
guide sleeve

Carrier



Left
side fit bolt

Part #:
BT4043



Part #:
BT4044

Right
side fit bolt

No cable fittings
or sensors

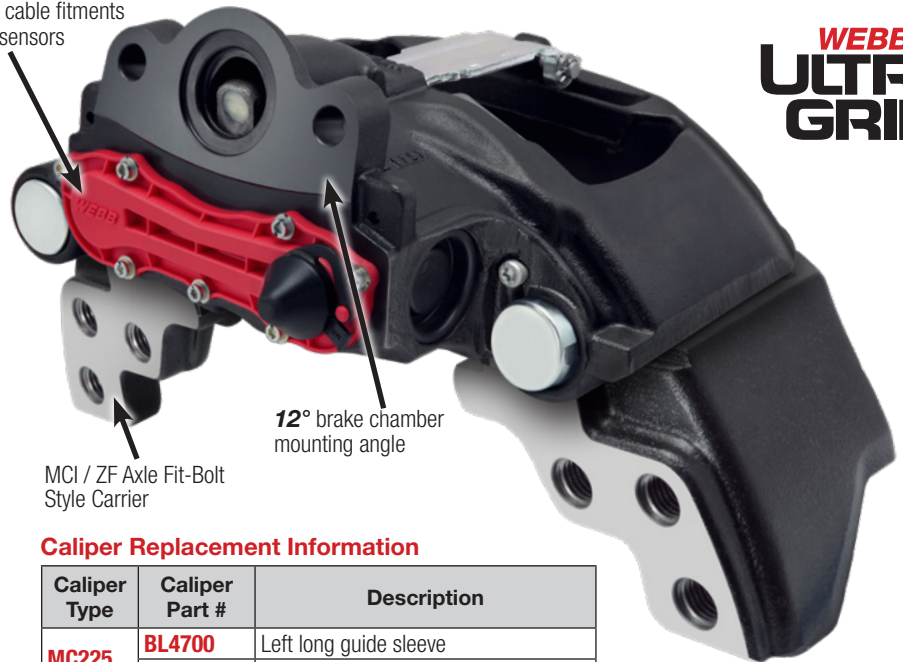

12° brake chamber
mounting angle

MCI / ZF Axle Fit-Bolt
Style Carrier

Caliper Replacement Information

Caliper Type	Caliper Part #	Description
MC225	BL4700	Left long guide sleeve
	BR4700	Right long guide sleeve

Caliper/Carrier Replacement Information

MC225	BL4700-43	LH long guide sleeve / 12° mounting angle / no sensor / carrier attached
	BR4700-43	RH long guide sleeve / 12° mounting angle / no sensor / carrier attached
	BL4700-44	LH long guide sleeve / 12° mounting angle / no sensor / carrier attached
	BR4700-44	RH long guide sleeve / 12° mounting angle / no sensor / carrier attached

Carrier Replacement Information

MC225	BT4043	Left side fit bolt
	BT4044	Right side fit bolt

Product Information

Applications:	2015+ MCI Coach or ZF Axles
Brake chamber mounting angle:	12°
Sensor Type:	None

Installation Kits Include



Guide Sleeves

Pad Retainer

Available Service Kits



Tappet Boot Kit
KS0400



Guide Sleeve Kit
KS0205



Chain Cover Kit
KS0300

For additional service kits refer to page 18.

Manufacturers' and other wholesaler's part numbers used in this catalog are for cross reference purposes only and do not imply anything about the origin or manufacturer of the product.

Caliper Type: NH225

Caliper Assemblies

Typically used on specialty and refuse applications.
Sold as assemblies only.

WEBB
ULTRA
GRIP™
with
Enviroshield
Technology

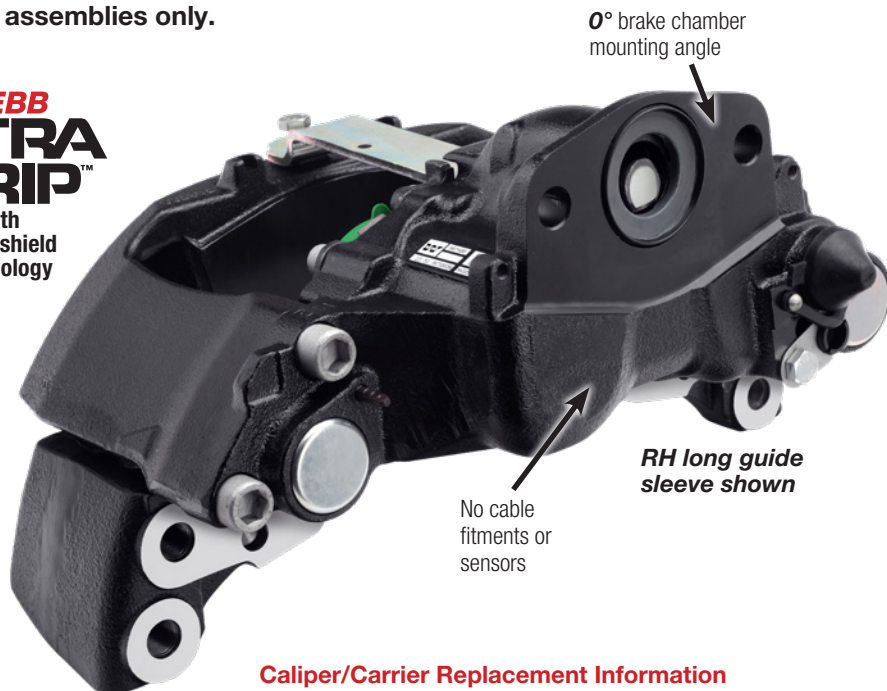

Caliper/Carrier Replacement Information

NH225	ML4410-80	LH long guide sleeve / 0° mounting angle / no sensor / carrier attached
	MR4410-80	RH long guide sleeve / 0° mounting angle / no sensor / carrier attached
	ML4420-80	LH long guide sleeve / 0° mounting angle / no sensor / carrier attached
	MR4420-80	RH long guide sleeve / 0° mounting angle / no sensor / carrier attached
	ML4410-84	Volvo/Mack LH long guide sleeve / 0° mounting angle / no sensor / carrier attached
	MR4410-84	Volvo/Mack RH long guide sleeve / 0° mounting angle / no sensor / carrier attached

Product Information

Applications:	Specialty/ Refuse
Brake chamber mounting angle:	0°
Sensor Type:	None

Installation Kits Include



Available Service Kits



For additional service kits refer to page 18.
Manufacturers' and other wholesaler's part numbers used in this catalog are for cross reference purposes only and do not imply anything about the origin or manufacturer of the product.



Webb heavy-duty NH225 calipers are equipped with a robust centralized gear-driven adjuster, offering enhanced reliability and durability.

Built to handle the toughest applications!

- Robust, centralized gear-driven adjuster enhances reliability and durability
- Upgraded housing design provides enhanced sealing, significantly reducing the chance of water intrusion
- Twin piston design ensures balanced brake pad distribution, optimizing braking action
- Induction-hardened abutments minimize carrier wear from brake pad sliding
- Stainless steel visual wear indicator allows for easy "wheels-on" brake pad inspection
- An excellent choice for vocational and specialty applications!



KITS AND ACCESSORIES

<p>KS0200 Guide Sleeve Kit NS225</p>	<p>KS0205 Guide Sleeve Kit MC225</p>	<p>KS0215 Guide Sleeve Kit NS225, LN225</p>	<p>KS0220 Guide Sleeve Kit LN225</p>
<p>KS0250 Guide Sleeve Kit NH225</p>	<p>KS0400 Tappet Boot Kit NS225</p> <p>Enviroshield Technology</p>	<p>KS0450 Guide Sleeve Kit LN225</p>	<p>KS0120 Pad Retainer Kit NS225, LN225</p>
<p>KS0130 Pad Retainer Kit MC225</p>	<p>KS0140 PWVI Pin NS225, LN225</p>	<p>KS0300 Plain Chain Cover Kit NS225, MC225</p>	<p>KS0335 Chain Cover Linear Sensor Fitted NS225</p> <p>(Use with screw-on or clip-on connectors)</p>
<p>KS0340 Chain Cover Stepped Sensor Fitted NS225</p> <p>(Use with screw-on or clip-on connectors)</p>	<p>KS0370 Chain Cover Linear Sensor Fitted LN225</p> <p>(Use with screw-on or clip-on connectors)</p>	<p>KS0375 Chain Cover Stepped Sensor Fitted LN225</p> <p>(Use with screw-on or clip-on connectors)</p>	<p>KS0350 Adjuster Cap Kit NS225, LN225, MC225</p>
<p>KS0500 Cap & Grease Kit NS225, LN225</p> <p>(Use with screw-on or clip-on connectors)</p>	<p>KS0505 Cap & Grease Kit MC225</p>	<p>KS0010 Caliper Service Tool NS225, LN225, MC225</p>	<p>KS0020 End Cap Fitting Kit NS225, LN225, MC225</p>

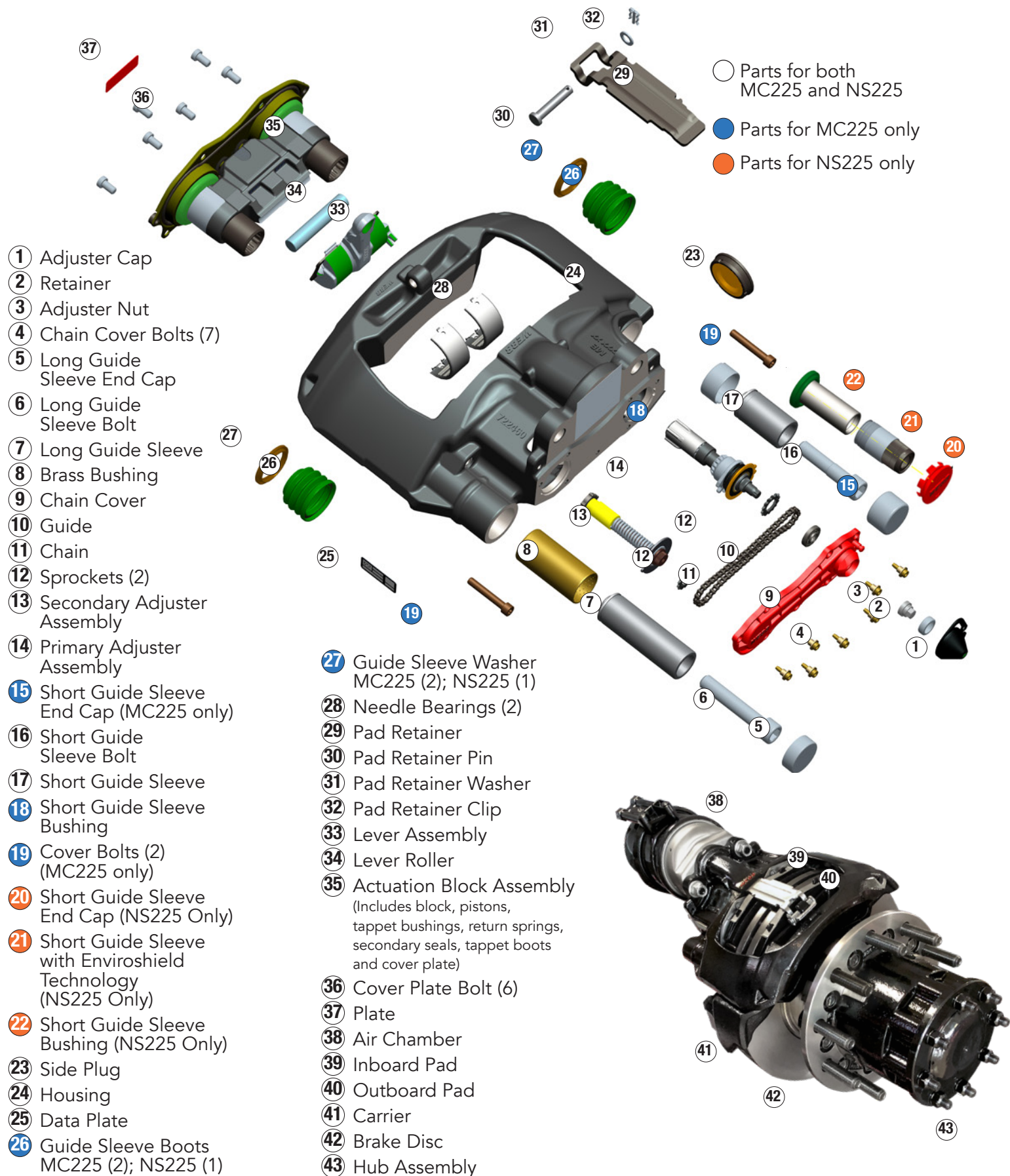

- 1 Adjuster Cap
- 2 Retainer
- 3 Adjuster Nut
- 4 Chain Cover Bolts (7)
- 5 Long Guide Sleeve End Cap
- 6 Long Guide Sleeve Bolt
- 7 Long Guide Sleeve
- 8 Brass Bushing
- 9 Chain Cover
- 10 Guide
- 11 Chain
- 12 Sprockets (2)
- 13 Secondary Adjuster Assembly
- 14 Primary Adjuster Assembly
- 15 Short Guide Sleeve End Cap (MC225 only)
- 16 Short Guide Sleeve Bolt
- 17 Short Guide Sleeve
- 18 Short Guide Sleeve Bushing
- 19 Cover Bolts (2) (MC225 only)
- 20 Short Guide Sleeve End Cap (NS225 Only)
- 21 Short Guide Sleeve with Enviroschild Technology (NS225 Only)
- 22 Short Guide Sleeve Bushing (NS225 Only)
- 23 Side Plug
- 24 Housing
- 25 Data Plate
- 26 Guide Sleeve Boots MC225 (2); NS225 (1)

- 27 Guide Sleeve Washer MC225 (2); NS225 (1)
- 28 Needle Bearings (2)
- 29 Pad Retainer
- 30 Pad Retainer Pin
- 31 Pad Retainer Washer
- 32 Pad Retainer Clip
- 33 Lever Assembly
- 34 Lever Roller
- 35 Actuation Block Assembly (Includes block, pistons, tappet bushings, return springs, secondary seals, tappet boots and cover plate)
- 36 Cover Plate Bolt (6)
- 37 Plate
- 38 Air Chamber
- 39 Inboard Pad
- 40 Outboard Pad
- 41 Carrier
- 42 Brake Disc
- 43 Hub Assembly

FITTING INSTRUCTIONS FOR MC225, NS225 & LN225 CALIPERS

Symbol Legend

Warning	Important Hint	Important Specification	Visual Inspection Required	Take Notes	Use suitable lifting equipment	Read Carefully	Important Torque Spec	Listen for Clicks

Please pay special attention to instructions in RED.

Caliper Identification

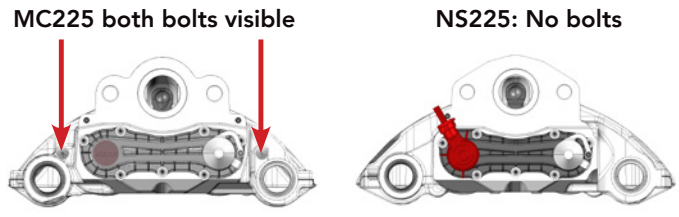

Fitting Instructions Intro for MC225/NS225/LN225



DO NOT use air wrenches or hammers. Their use will damage the product, prevent correct function and will void the warranty.

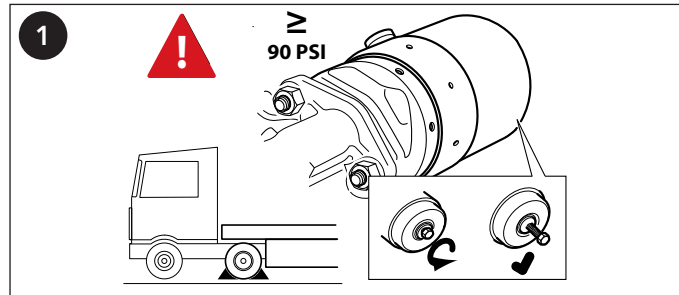

1 Ensure the vehicle is securely chocked before releasing the parking brake. Remove the wheel as recommended by the manufacturer. Cage the spring brake or use a minimum hold off pressure of 90 psi (6 bar). Remove the air chamber and disconnect the pad wear sensor cable (if fitted) from the caliper.

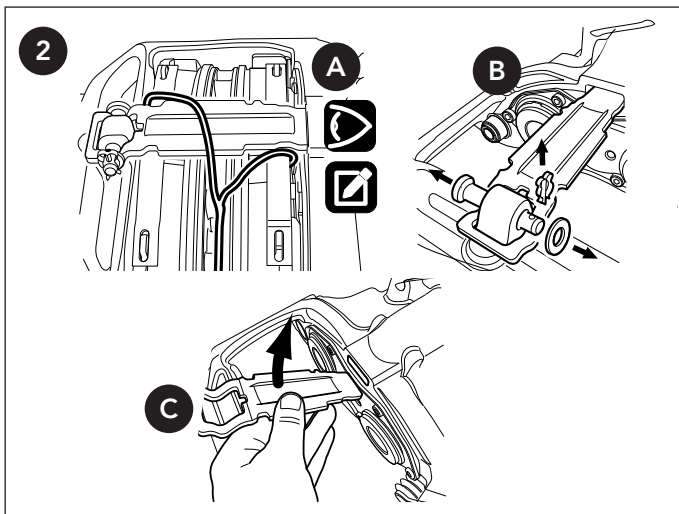

2 Make note of the pad wear warning indicator (PWWI) cable arrangement (if fitted) **A** and remove the pads and retainer. Remove the pad retainer by removing the clip, washer and pin. **B** Replace used parts with the new ones provided. Remove both pads and springs and visually inspect; replace if worn or damaged. Remove the guide sleeve protective caps, guide sleeves and bolts. **C**

! Before removing the guide sleeve bolts, ensure that the caliper cannot move or fall to avoid injury.

Replace used parts with the new ones provided. Remove the old caliper assembly using suitable lifting equipment for the caliper. Visually inspect and, if necessary, clean the carrier and disc; replace if worn or damaged.

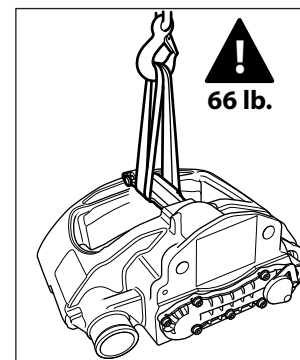
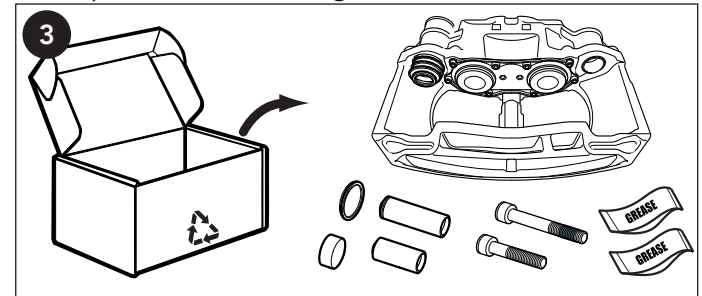

3 Remove the new caliper and guide sleeve kit from the packaging. Use suitable lifting equipment for the caliper.

For MC225 see next page.
For NS225 & LN225 see page 22

FITTING INSTRUCTIONS FOR MC225 & NS225 CALIPERS

Fitting Instructions For MC225 Only (For NS225 & LN225 see page 22)

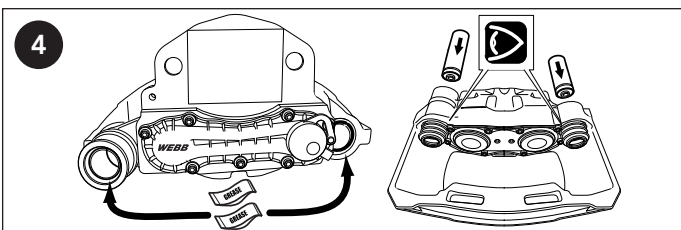

4 Grease both guide sleeves using the grease packets provided. Slide the guide sleeves in to the bushings in the directions indicated above.

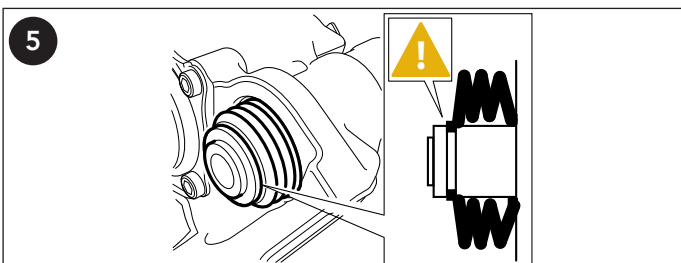

5 Insert the boots into the sealing groove in the guide sleeves ensuring they seal correctly all around the sleeves.

! Apply a small amount of grease to help the boot slip into the groove.

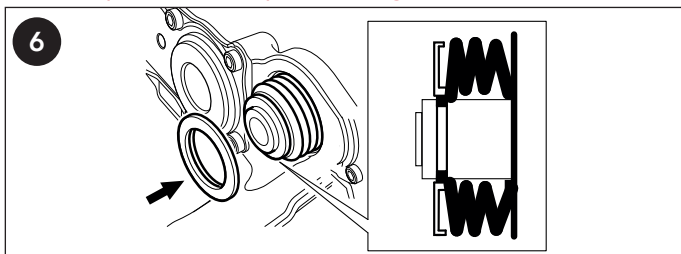

6 Position the plastic washer over the boots to retain them in the sealing groove in the guide sleeves. Ensure that the washer is in the correct orientation.

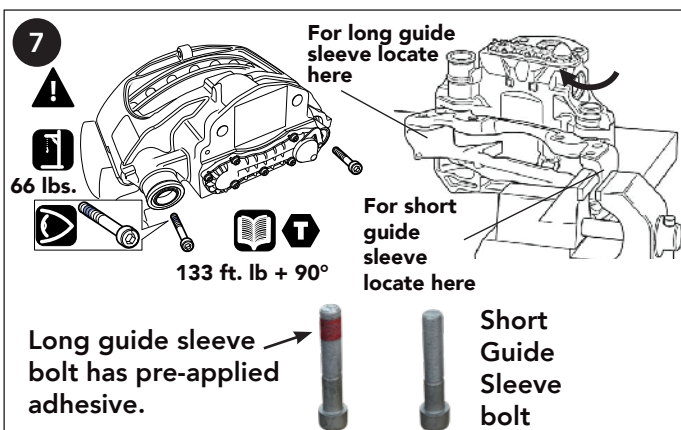

7 Ensure the carrier threads are clean, dry and free of lubrication and/or residuals of pre-applied adhesive (the long guide sleeve bolt has a pre-applied adhesive).

If the caliper is being fitted on the vehicle, lift the caliper over the carrier and insert the bolts into the carrier. Use suitable lifting equipment for the caliper. Ensure the correct new bolts are used for each guide sleeve. If the caliper is being fitted away from the vehicle, attach the carrier to the caliper by hand tightening each bolt into the carrier. Then, move the assembly to a vice and ensure the carrier is securely located to resist the bolt torque. Tighten both bolts to 133 ft. lb., then tighten by a further 90 degrees. Check that the caliper slides easily on the guide sleeves.

! The pre-assembled pad retainer can be used to lift the caliper if done with care. Never hold the caliper with your fingers between the caliper and the carrier - there is a risk of injury.

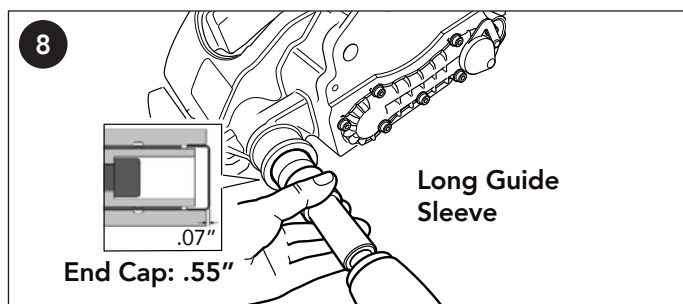

8 Insert the protective cap for the long guide sleeve into the caliper bore – protective cap and bore must be clean and free from lubrication. Press the metal protective cap into the long guide sleeve bore ensuring it is seated squarely until the cap is flush with the cast boss.

! Fitting the protective cap(s) can only be done after the caliper has been fully bolted to the carrier. The guide sleeve boot(s) must be in a compressed condition or the caliper's freedom of movement will be limited.

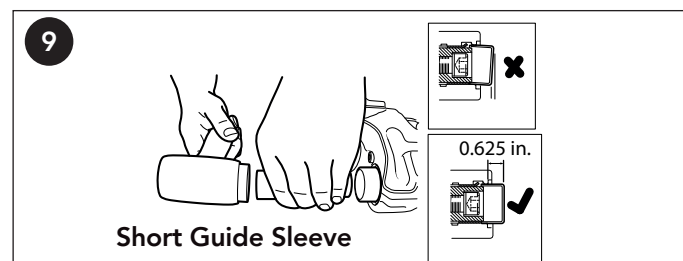

9 Insert the protective cap for the short guide sleeve into the caliper bore – protective cap and bore must be clean and free from lubrication. Press the protective cap into the bore until the cap protrudes .625" from the cast boss, ensuring it is seated squarely.

This completes steps for MC225, skip to step 10 on page 23 to continue.

FITTING INSTRUCTIONS FOR MC225 & NS225 CALIPERS

Fitting Instructions For NS225 & LN225 Only (For MC225 see page 21)

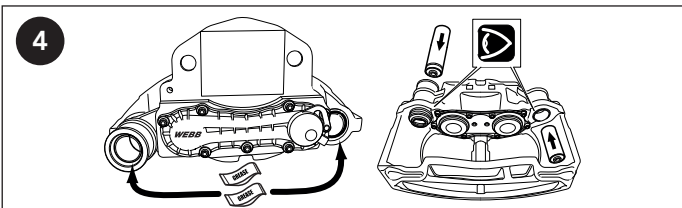

4 Grease both guide sleeves using the grease packets provided. Slide the guide sleeves into the brass bushing in the directions indicated above

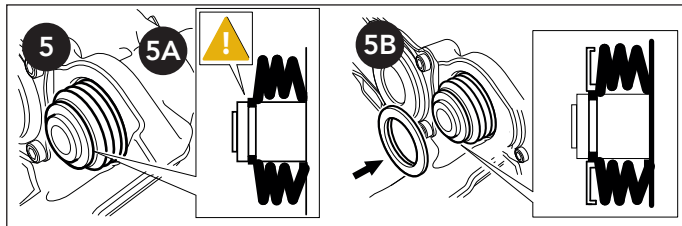

5 Insert the boot into the sealing groove in the long guide sleeve ensuring it seals correctly all around the sleeve.

! Apply a small amount of grease to help the boot slip into the groove.

5B Position the plastic washer over the boot to retain it in the sealing groove in the long guide sleeve. Ensure that the washer is in the correct orientation.

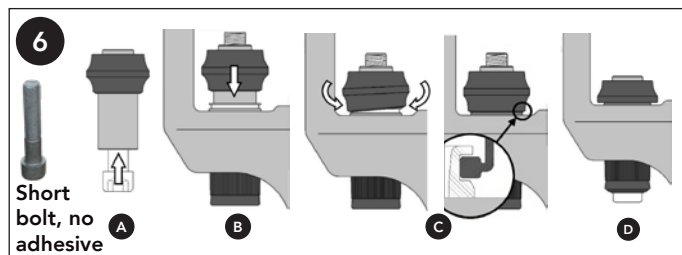

6 **A** Fit the short bolt into the guide sleeve with pre-assembled rubber boot in the direction indicated.
B Slide the guide sleeve and bolt into the rubber bushing in the direction indicated.
C Insert the boot into the sealing groove in the housing retainer ensuring it seals correctly all round the groove.
D Roll the guide sleeve boot bellows back against the housing and push the bolt back into the rubber bushing to provide clearance with the carrier during assembly.



7 Ensure the carrier threads are clean, dry and free of lubrication and/or residuals of pre-applied adhesive (the long guide sleeve bolt has a pre-applied adhesive). If the caliper is being fitted on the vehicle, lift the caliper over the carrier and insert the bolts into the carrier. Use suitable lifting equipment for the caliper. Ensure the correct new bolts are used for each guide sleeve. If the caliper is being fitted away from the vehicle, attach the carrier to the caliper by hand tightening each bolt into the carrier. Then, move the assembly to a vice and ensure the carrier is securely located to resist the bolt torque. Tighten both bolts to 133 ft. lb., then tighten by a further 90 degrees. Check that the caliper slides easily on the guide sleeves.

! The pre-assembled pad retainer can be used to lift the caliper if done with care. Never hold the caliper with your fingers between the caliper and the carrier - there is a risk of injury.

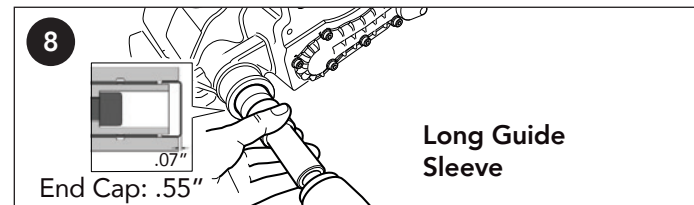

8 Insert the protective cap for the long guide sleeve into the caliper bore – protective cap and bore must be clean and free from lubrication. Press the metal protective cap into the long guide sleeve bore ensuring it is seated squarely until the cap is flush with the cast boss.

! Fitting the protective cap(s) can only be done after the caliper has been fully bolted to the carrier. The guide sleeve boot(s) must be in a compressed condition or the caliper's freedom of movement will be limited.

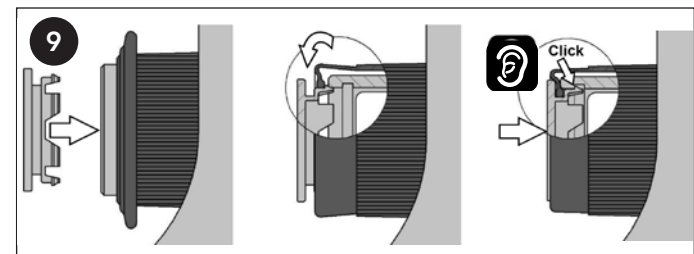

9 Stretch the rubber bushing bellows over the short guide sleeve and position the plastic cap in the end of the guide sleeve bore – do not push into the bore yet. Slide the bellows back over the plastic cap, ensuring it locates correctly all around the groove, and then push the cap firmly into the guide sleeve so that it clicks into place.

This completes steps for NS225 and LN225, see next page to finish.

FITTING INSTRUCTIONS FOR MC225 & NS225 CALIPERS

Fitting Instructions Finish for MC225, NS225 & LN225

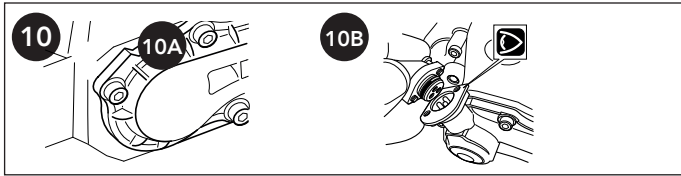

10 If the carrier was removed from the vehicle, reinstall the caliper and carrier assembly in accordance with the vehicle manufacturer's recommendations. Reconnect the pad wear sensor cable connector (where applicable).

10A Chain cover without pad wear sensor - no action necessary.

10B Chain cover with screw/clip type connector - engage the connector and then clip or tighten the 2 screws.

! Ensure the pad wear sensor cable connector is clean and free from grease, dirt and moisture.

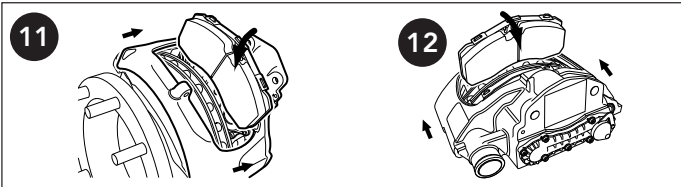

11 Slide caliper inboard and insert inner brake pad and spring.

12 Slide caliper outboard and insert outer brake pad and spring.

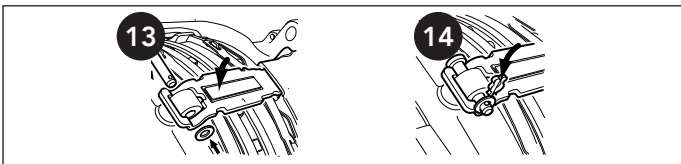

13 Insert the new pad retainer in the slot in the caliper and depress to enable the insertion of the pad retainer pin. Position the washer over the pad retainer pin.

14 Press the clip through the pad retainer pin to secure.

! It is recommended that the pad retainer pin, where possible, is installed with pin head uppermost.

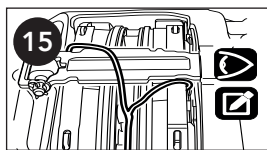

(where applicable).

15 Refit the pad wear warning indicator (PWWI) cable and clips in the same orientation as when removed. Reconnect the pad wear sensor cable connector

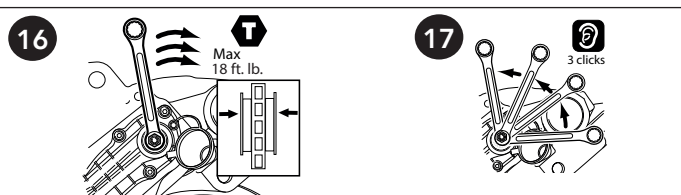

16 Turn the adjuster clockwise until the pads come into contact with the disc - do not exceed 18 ft. lb. torque.

17 Turn back the adjuster 3 clicks and check the pad-to-disc running clearance.

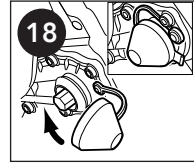

18 Check for free rotation of the disc. Refit the adjuster cap.

! Opening or dismantling of the caliper is not authorized and will void your warranty.

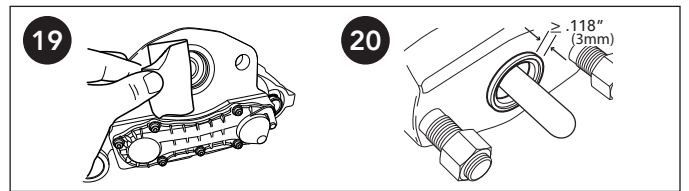

19 Remove the adhesive tape in the area of the air chamber attachment. Take care that no dirt enters the brake caliper.

20 Visually inspect and, if necessary, clean the air chamber mounting and sealing surface. Replace if damaged.

! If the air chamber seal protrudes less than .188" (3 mm) the brake chamber must be replaced.

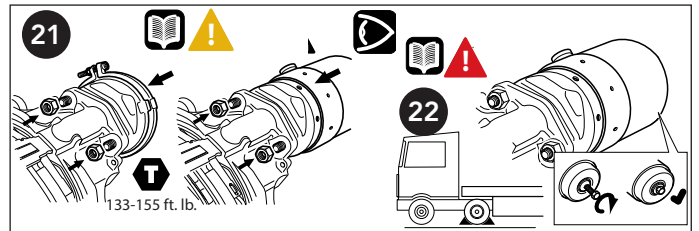

21 Reinstall the air chamber in the same orientation as when removed, in accordance with the vehicle manufacturer's recommendations. Tighten the nuts to 133-155 ft. lb. (unless specified differently in the vehicle manufacturer's recommendations).

! In order not to tilt the air chamber during its attachment, the nuts must be gradually tightened symmetrically with a suitable tool.

22 Replace the wheel as recommended by the vehicle manufacturer. Uncage the spring brake and apply the parking brake prior to removing the chocks from the vehicle. After releasing the parking brake, apply the brake 10 times and then road test the vehicle.

For additional information, please visit us at WebbADB.com

QUALITY ASSURANCE/WARRANTY



Quality Assurance

The end of the line test station shown above ensures correct performance of every caliper we produce. All information generated by our test station is recorded and traceable via the ID tag placed onto every Webb caliper (shown right). The ID tag will only be produced if the caliper passes all internal performance criteria.

Warranty

Webb Air Disc Brake Calipers cannot compensate for other deficiencies in the brake system, therefore, please ensure all other components of the air disc brake system are functioning properly before contacting Webb Wheel Products for warranty consideration. Webb Wheel Products, Inc. ("Webb Wheel") warrants to the original retail purchaser of Webb Air Disc Brake calipers, that when installed and maintained on vehicles in accordance with Webb Air Disc Brake installation and maintenance instructions, the Webb Air Disc Brake calipers will be free of defects in material or workmanship under normal use for a specified period as outlined in: https://webbairdiscbrakes.com/warranty_aftermarket.html

The warranty period begins from the date of purchase from an authorized Webb distributor and should be registered online at <https://webbairdiscbrakes.com/register/>

If proof of purchase is not provided when filing a warranty claim, the start of the warranty period defaults back to the caliper's original date of manufacture.



WEBB TO KNORR-BREMSE/BENDIX CROSS REFERENCE

Knorr-Bremse/ Bendix, Meritor Part #	Webb Part #	Knorr-Bremse/ Bendix, Meritor Part #	Webb Part #	Knorr-Bremse/ Bendix, Meritor Part #	Webb Part #	Knorr-Bremse/ Bendix, Meritor Part #	Webb Part #
802090	BR4700-41	K021300	BL4700	K082531	BL4700-43	K109960	BL4700
802091	BL4700-41	K029092	KR1400	K082532	BR4700-44	K109961X	BR4700-41
802984	BR4400-40	K029093	KL1400	K082533	BL4700-44	K109961X	BR4700
802985	BL4400-40	K029094	KR1400	K096999	BR4700-43	K109962X	BL4700-41
ML4410-80	EX225H201	K029095	KL1400	K097000	BL4700-43	K109962X	BL4700
MR4410-80	EX225H202	K029098	KR1400	K097001	BL4700-44	K110105	KR1400
ML4420-80	EX225H301	K029099	KL1400	K097002	BL4700-44	K110106	KL1400
MR4420-80	EX225H302	K029100	KR1400	K097198	KR1400	K110269	KR1400
*ML4410-84	EX225H227	K029101	KL1400	K097199	KL1400	K110270	KL1400
*MR4410-84	EX225H228	K034699	KR1400	K097844	BR4700	K110285	KR1400
ii35957	KR1400-07	K034700	KL1400	K097844SC	BR4700	K110286	KL1400
ii35958	KL1400-07	K035432	KR1400	K097845	BL4700	K113887X	BR4400-40
K010173	KL6900B-02	K035433	KL1400	K097845SC	BL4700	K113887X	BR4400
K010172	KR6900B-02	K043288	BT4040	K097846	BR4700-42	K113888X	BL4400-40
K001273	KT1004	K045790	KL1400	K097846	BR4700	K113888X	BL4400
K001278	KT1001	K045791	KR1400	K097846SC	BR4700-42	K114142	KR1400
K001520	KT1007	K045792	KL1400	K097847	BL4700-42	K114143	KL1400
K001529	KT1002	K045793	KR1400	K097847	BL4700	K124524	KR1400
K001530	KT1002	K045794	KL1400	K097847SC	BL4700-42	K125625	KR1400
K002964	KL6900B	K045795	KR1400	K097848	BR4700	K125627	KR1400
K002965	KR6900B	K048681	KR1400	K097849	BL4700	K125628	KR1400
K003783	KL1400	K048682	KL1400	K097850	BR4700-41	K125629	KR1400
K003784	KR1400	K051223	KR1400	K097850	BR4700	K125630	KR1400
K003803	KL1400	K051224	KL1400	K097850SC	BR4700-41	K125631	KL1400
K003804	KR1400	K051853	BT4041	K097851	BL4700-41	K125632	KL1400
K003809	KL1400B	K053667	KR1400	K097851	BL4700	K125633	KL1400
K003810	KR1400B	K053667	KR1400-08	K097851SC	BL4700-41	K125665	KL1400
K003811	KL1400A	K053668	KL1400	K097862	BR4700-43	K125666	KL1400
K003812	KR1400A	K053668	KL1400-08	K097862SC	BR4700-43	K125667	KR1400
K014065	KL6900A	K056559	BT4042	K097863	BL4700-44	K125668	KR1400
K014066	KR6900A	K064529	KR1400B-04	K097863SC	BL4700-44	K125672	KL1400
K014989	KR1400A-01	K064530	KL1400B-04	K097864	BR4700-44	K128340	KL1400
K014990	KL1400A-01	K081142	BR4700-41	K097864SC	BR4700-44	K128341	KR1400
K015013	KR1400-01	K081142	BR4700	K097865	BL4700-43	K129298	BR4400
K015014	KL1400-01	K081143	BL4700-41	K097865SC	BL4700-43	K129299	BL4400
K015015	KR1400-01	K081143	BL4700	K100095B	KR6400A-01	K12AT	KL1400
K064526	KL6900A-02	K081256	BR4700-42	K100096B	KL6400A-01	K147135	BL4700-42
K064525	KR6900A-02	K081256	BR4700	K108189	KR1400	K147136	BR4700-42
K017864	KT1008	K081257	BL4700-42	K108190	KL1400	K147429	BL4700-41
K019174	BR4700	K081257	BL4700	K109547	KR1400-02	K147430	BR4700-41
K019175	BL4700	K081258	BR4700	K109548	KL1400-02	K171554	BR4700-43
K019180	BR4400	K081258	BR4700	K109957X	BR4700-42	K171555	BL4700-44
K019181	BL4400	K081259	BL4700	K109957X	BR4700	K171556	BR4700-44
K021299	BR4700-42	K082260	BT4043	K109958X	BL4700-42	K171557	BL4700-43
K021299	BR4700	K082261	BT4044	K109958X	BL4700		
K021300	BL4700-42	K082530	BR4700-43	K109959	BR4700		

*Volvo/Mack applications.



Your Wheel-End Experts
www.WebbADB.com • 800-633-3256



A Marmon | Berkshire Hathaway Company

©2024 Webb Wheel Products, Inc. • SD-133 R73